

序号	品名	材质
①	0.5镀镍胶态 (DIL.5)	LCP UL94V-0本色
②	0.5镀镍端子 (DIL.5)	磷青铜/表面镀锡 镀金
③	0.5镀镍后推 (DIL.5)	LCP UL94V-0 黑色
④	0.5镀镍薄片 (DIL.5)	磷青铜/表面镀锡

技术指标:

1. 塑件表面应光洁、无毛边、无明显收缩、缺陷、裂纹等现象。
2. 温度范围: $-25^{\circ}\text{C} \sim 85^{\circ}\text{C}$ 。
3. 额定电压: 50V, AC/DC(等效)。
4. 接触电阻: $\leq 0.03\Omega$ 。
5. 绝缘电阻: $\geq 500\text{M}\Omega$

CKT	DIMA	DIME	DIMC	CKT	DIMA	DIME	DIMC
4	1.50	6.20	2.53	33	16.00	20.70	17.03
5	2.00	6.70	3.03	34	16.50	21.20	17.53
6	2.50	7.20	3.53	35	17.00	21.70	18.03
7	3.00	7.70	4.03	36	17.50	22.20	18.53
8	3.50	8.20	4.53	37	18.00	22.70	19.03
9	4.00	8.70	5.03	38	18.50	23.20	19.53
10	4.50	9.20	5.53	39	19.00	23.70	20.03
11	5.00	9.70	6.03	40	19.50	24.20	20.53
12	5.50	10.20	6.53	41	20.00	24.70	21.03
13	6.00	10.70	7.03	42	20.50	25.20	21.53
14	6.50	11.20	7.53	43	21.00	25.70	22.03
15	7.00	11.70	8.03	44	21.50	26.20	22.53
16	7.50	12.20	8.53	45	22.00	26.70	23.03
17	8.00	12.70	9.03	46	22.50	27.20	23.53
18	8.50	13.20	9.53	47	23.00	27.70	24.03
19	9.00	13.70	10.03	48	23.50	28.20	24.53
20	9.50	14.20	10.53	49	24.00	28.70	25.03
21	10.00	14.70	11.03	50	24.50	29.20	25.53
22	10.50	15.20	11.53	51	25.00	29.70	26.03
23	11.00	15.70	12.03	52	25.50	30.20	26.53
24	11.50	16.20	12.53	53	26.00	30.70	27.03
25	12.00	16.70	13.03	54	26.50	31.20	27.53
26	12.50	17.20	13.53	55	27.00	31.70	28.03
27	13.00	17.70	14.03	56	27.50	32.20	28.53
28	13.50	18.20	14.53	57	28.00	32.70	29.03
29	14.00	18.70	15.03	58	28.50	33.20	29.53
30	14.50	19.20	15.53	59	29.00	33.70	30.03
31	15.00	19.70	16.03	60	29.50	34.20	30.53
32	15.50	20.20	16.53				

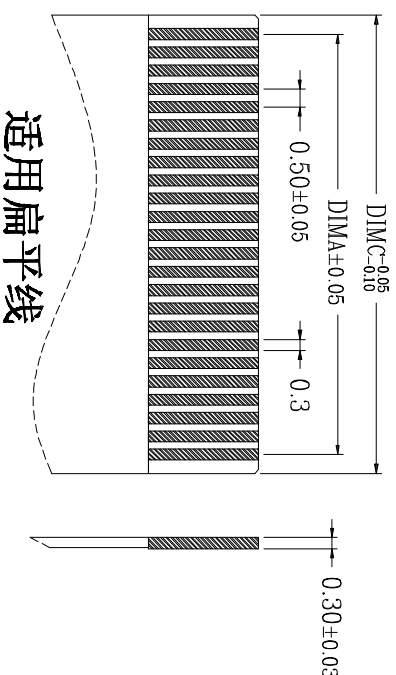
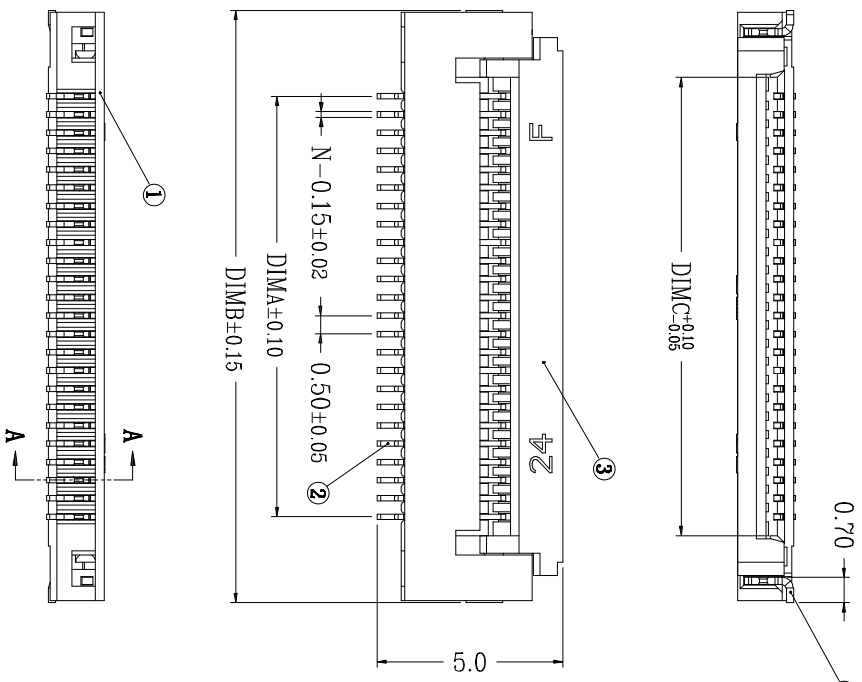
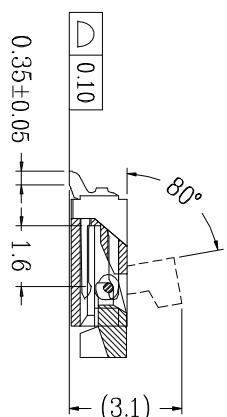
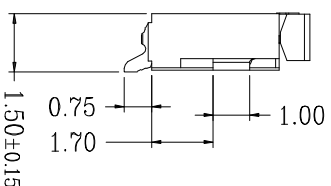
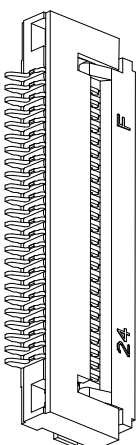

适用线路板

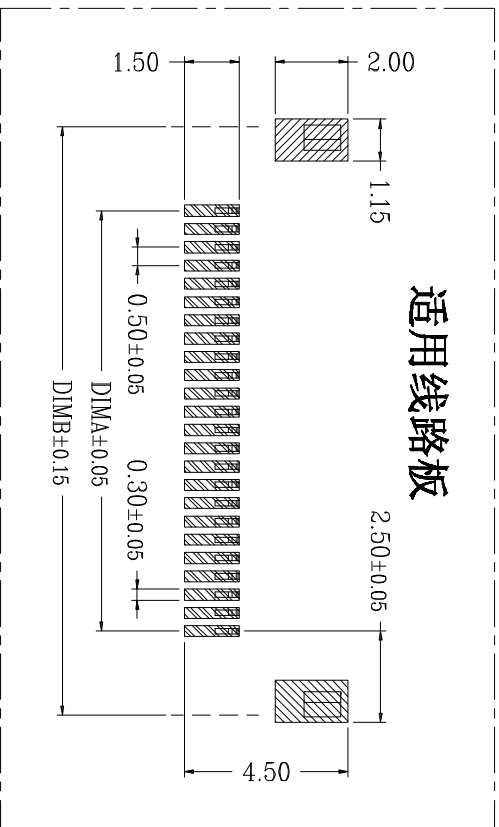

适用扁平线

CKT	DIMA	DIME	DIMC
4	1.50	6.20	2.53
5	2.00	6.70	3.03
6	2.50	7.20	3.53
7	3.00	7.70	4.03
8	3.50	8.20	4.53
9	4.00	8.70	5.03
10	4.50	9.20	5.53
11	5.00	9.70	6.03
12	5.50	10.20	6.53
13	6.00	10.70	7.03
14	6.50	11.20	7.53
15	7.00	11.70	8.03
16	7.50	12.20	8.53
17	8.00	12.70	9.03
18	8.50	13.20	9.53
19	9.00	13.70	10.03
20	9.50	14.20	10.53
21	10.00	14.70	11.03
22	10.50	15.20	11.53
23	11.00	15.70	12.03
24	11.50	16.20	12.53
25	12.00	16.70	13.03
26	12.50	17.20	13.53
27	13.00	17.70	14.03
28	13.50	18.20	14.53
29	14.00	18.70	15.03
30	14.50	19.20	15.53
31	15.00	19.70	16.03
32	15.50	20.20	16.53

CUSTOMER DRAWING

一般公差
GENERAL TOLERANCE

X ±0.20
XX ±0.20
XXX ±0.10
ANGLES ±3°



东莞市红都电子有限公司
DongGuan HongDu Electronic Co.,Ltd

制图 (DND): Kevin 0006177
品名 (TITLE): FPC 0.5Pitch 1.5H ZIF R/A
Lower Contact Connector

审核 (CMD):
料号 (PART NO.): FPC0515A-XXX-009W
单位 (UNITS): 1 Of 1
张数 (SHEET): 1 Of 1
图幅 (SIZE): A4

修订	修改内容	日期	签名	日期
SER	REVISION DESCRIPTION	DATE	SIGNATURE	DATE