

适用线路板

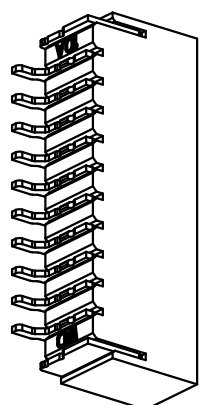

3D View

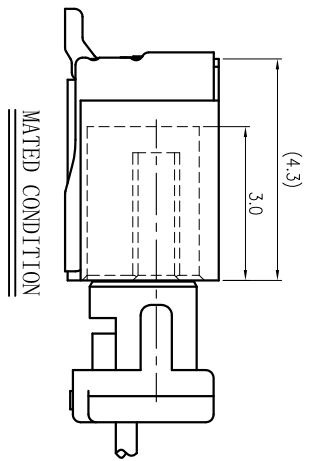
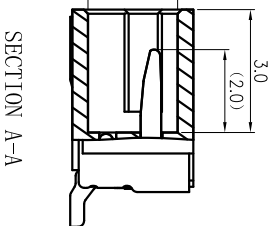
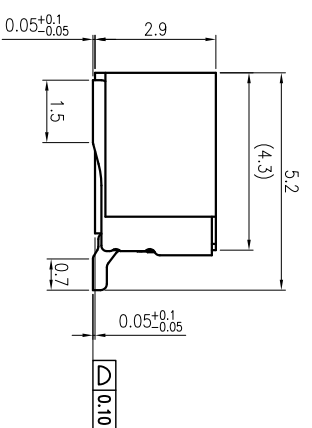

序号	品名	材质
1	1.0- E型卧式VIB胶芯	LCP UL94V-0 自然色
2	1.0- E型卧式VIB端子	磷青铜/表面镀锡
3	1.0- E型卧式VIB铜片	黄铜/表面镀锡

CKT	DIM A	DIM B	DIM C
2	1.00	2.50	4.00
3	2.00	3.50	5.00
4	3.00	4.50	6.00
5	4.00	5.50	7.00
6	5.00	6.50	8.00
7	6.00	7.50	9.00
8	7.00	8.50	10.00
9	8.00	9.50	11.00
10	9.00	10.50	12.00
11	10.00	11.50	13.00
12	11.00	12.50	14.00
13	12.00	13.50	15.00
14	13.00	14.50	16.00
15	14.00	15.50	17.00
16	15.00	16.50	18.00
17	16.00	17.50	19.00
18	17.00	18.50	20.00
19	18.00	19.50	21.00
20	19.00	20.50	22.00
22	21.00	22.50	24.00
24	23.00	24.50	26.00
26	25.00	26.50	28.00

技术指标:

1. 塑件表面应光洁、无毛边、无明显收缩、缺陷、裂纹等现象。
  2. 温度范围: -25° C~85° C.
  3. 额定电压: 30V, AC/DC.
  4. 接触电阻: ≤0.02Ω.
  5. 绝缘电阻: ≥100MΩ.
  6. 额定电流:
- 适用电线型号: a. AWG#28:1.0A(per pin)  
b. AWG#30:1.0A(per pin)  
c. AWG#32:0.8A(per pin)

CUSTOMER DRAWING

一般公差  
GENERAL TOLERANCE

X ±0.30

XX ±0.25

XXX ±0.15

ANGLES ±2°



东莞市红都电子科技有限公司  
DONG GUAN SHI HONG DU ELECTRONICS TECHNOLOGY CO., LTD

品名(TITLE): 1.0mm VIB 胶贴 2.95H

料号(PART NO.): WTB1029-XX-00RW

比例(SCALE): 1:1